



Anti-flooding valves
+ cellar drains

01	Introduction	Page 05
02	Anti-flooding valves	Page 09
03	Utility and floor drains	Page 19
04	Product range	Page 31
05	Service	Page 46

01

Introduction

Page 05



“We are an innovative company – but we're also one big family.”

Harry Bauermeister,
Managing Director

The Dallmer family business is now in its fourth generation. And even if over the decades times have changed drastically, and along with it the production processes, one thing has remained the same: All Dallmer products are developed, designed and manufactured using state-of-the-art technology in Germany – more specifically, in Arnsberg. The “Made in Germany” seal of quality applies without reservations.

Investing in the future. Dallmer does not only invest money in state-of-the-art machine technology, but also in training and further education for its employees. This ensures that there is specialist know-how at the location.

Bringing together strengths. In order to produce drainage solutions which set standards, you need a genuine innovative spirit and a high degree of experience – and state-of-the-art technology.

Every detail counts. Quality is our top priority. If we all work towards this same goal, we are capable of meeting even the highest demands.



Headquarters in
Arnsberg

Production and
storage rooms



1913

02

Anti-flooding valves

Page 09

Anti-flooding valves: No more flooding

Safe in
every situation

No public sewer system can drain off extreme volumes of water, such as those occurring after cloudbursts or thunderstorms, which means that short-term overloading is unavoidable. This is why municipal drainage statutes generally stipulate that all rooms and courtyards below backflow level require protection against backflow. For this type of application, Dallmer manufactures its anti-flooding valves and backflow-proof cellar drains.

The Stausafe product series offers protection against flooding by means of shut-off devices for continuous pipelines with faecal-free wastewater (Stausafe E, H and RS). Anti-flooding valves conforming to DIN EN 13564 such as the Stausafe F offer protection for continuous pipelines for faecal wastewater. Even in the event of a complete power failure (e.g. storm), its safety functions will continue to operate for up to a further four days, thanks to an integrated emergency power supply (8× standard AA alkaline manganese 1.5 V batteries).

The high-quality and very durable stainless steel closure valves in Stausafe E, H and RS models are closed by means of the gravity principle, as automatic pendulum flaps, and as such they also protect against uninvited guests from the sewers.

DallSafe utility drains protect against flooding too. They are equipped with a triple safety device conforming to DIN EN 13564 and can be used in drain points for faecal-free wastewater, e.g. in level-access shower.

Discover our anti-flooding devices:
dallmer.com/cellar-anti-flooding



What else might interest you: The DallDrain point drains for floor drainage. Installation technicians are provided with an assembly-friendly, highly flexible floor drain for drainage of all sealed surfaces, for example in the bathroom, spa and cellar.

Discover the DallFlex system:
dallmer.com/dallflex



Stausafe RS

Anti-flooding valves

Stausafe

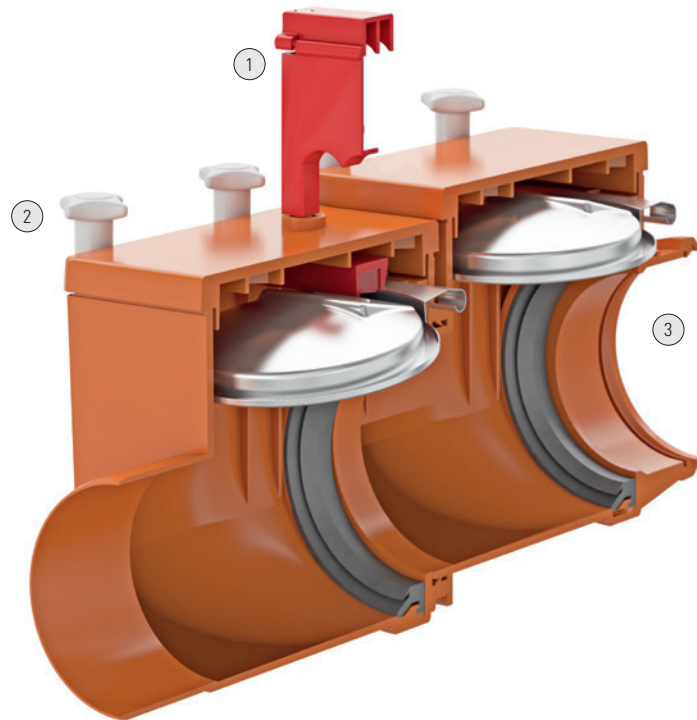

Variants



Stausafe E without emergency shut-off



Stausafe H with additional manual locking



Stausafe RS with additional manual locking and two anti-flooding flap-valves

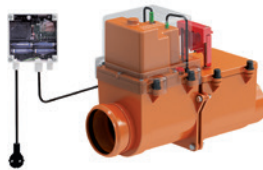

Stausafe F with additional electronic flooding sensor and manual locking

Material	ABS
Build-in height	220 – 349 mm*
Nominal width	DN 100 / DN 125 / DN 150 / DN 200*
Type Class	0 / 1 / 2 / 3 / 5* Complies with DIN EN 13564

*Depending on model version.

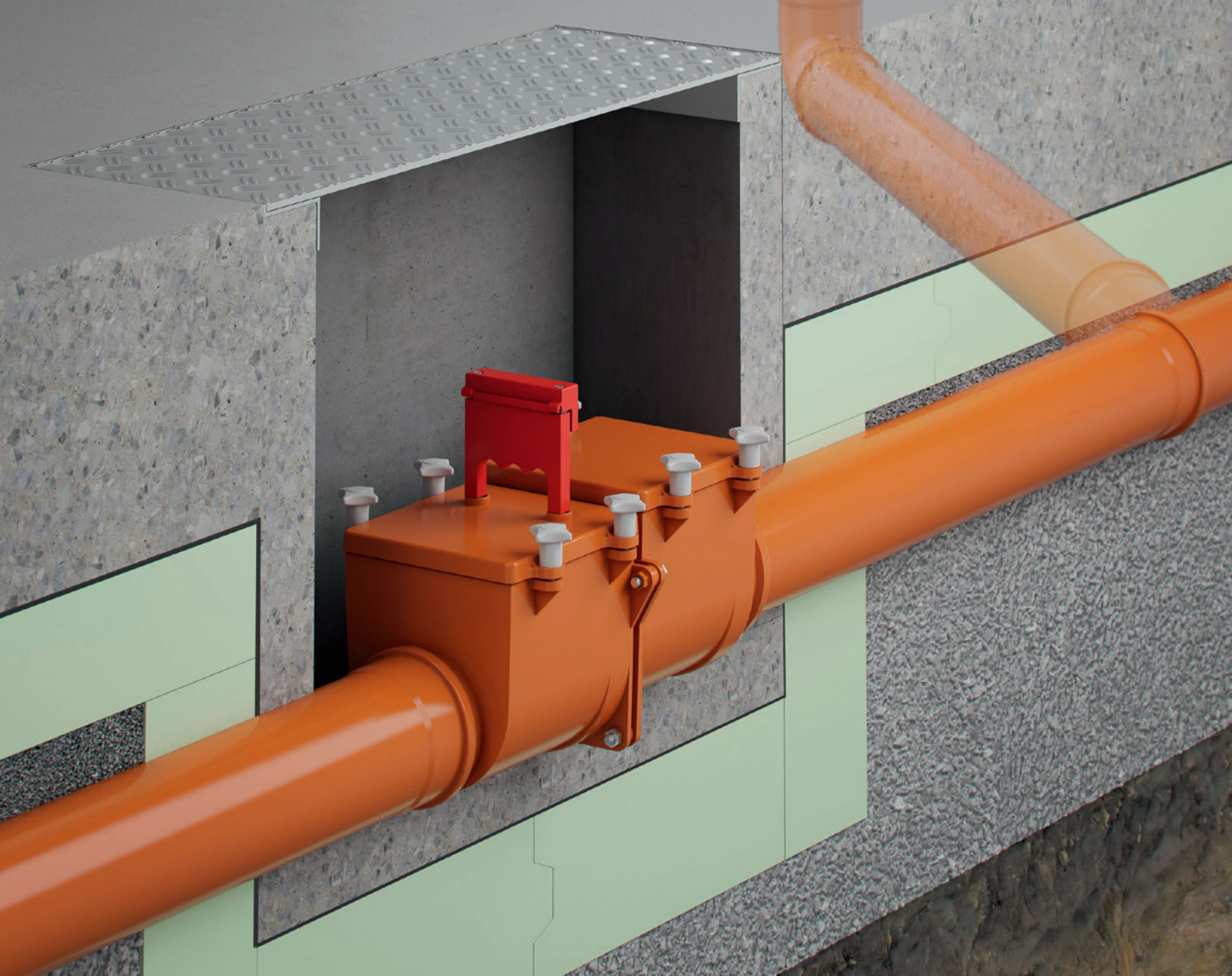

- ① Manual locking (emergency closure)
- ② Housing cover with tommy screws for tool-free maintenance
- ③ Two automatic anti-flooding flaps-valves made of stainless steel

Advantages

Designs for every need: The simple Stausafe E, Stausafe H with additional manual locking and the Stausafe RS version with additional manual locking and two anti-flooding flap-valves for increased safety. The highest level of protection: Stausafe F for wastewater with faecal waste, with motor-operated cover flap.

- Maintenance-friendly housing made from impact-proof ABS plastic
- Cover flaps that close automatically in the event of flooding
- Closure linkage made from stainless steel

Stausafe F

- Emergency power supplied by batteries
- Test pipe connection
- Control electronics in a surface-mounted box
- Optical / acoustic status display, BMS-enabled

Product information:
dallmer.com/stausafe



Mode of operation of the Stausafe F

Mode of operation in detail

A probe in the anti-flooding valve reacts to wetting and an electrically driven spindle closes the cover flap of the valve. Even in the event of a complete power failure (e.g. storm), all safety functions will continue to operate for up to a further four days, thanks to an integrated emergency power supply (8 × standard AA alkali manganese 1.5 V batteries).

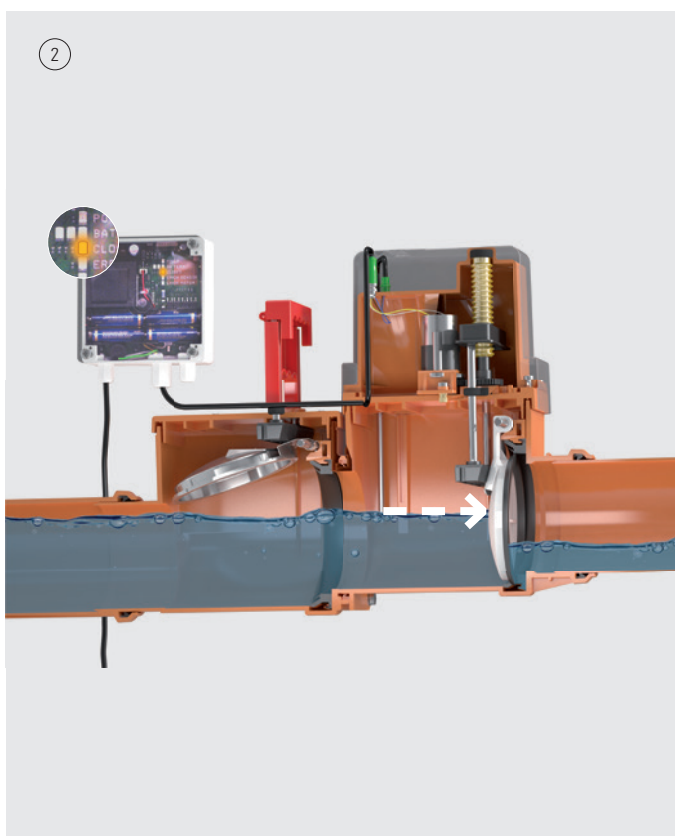

③

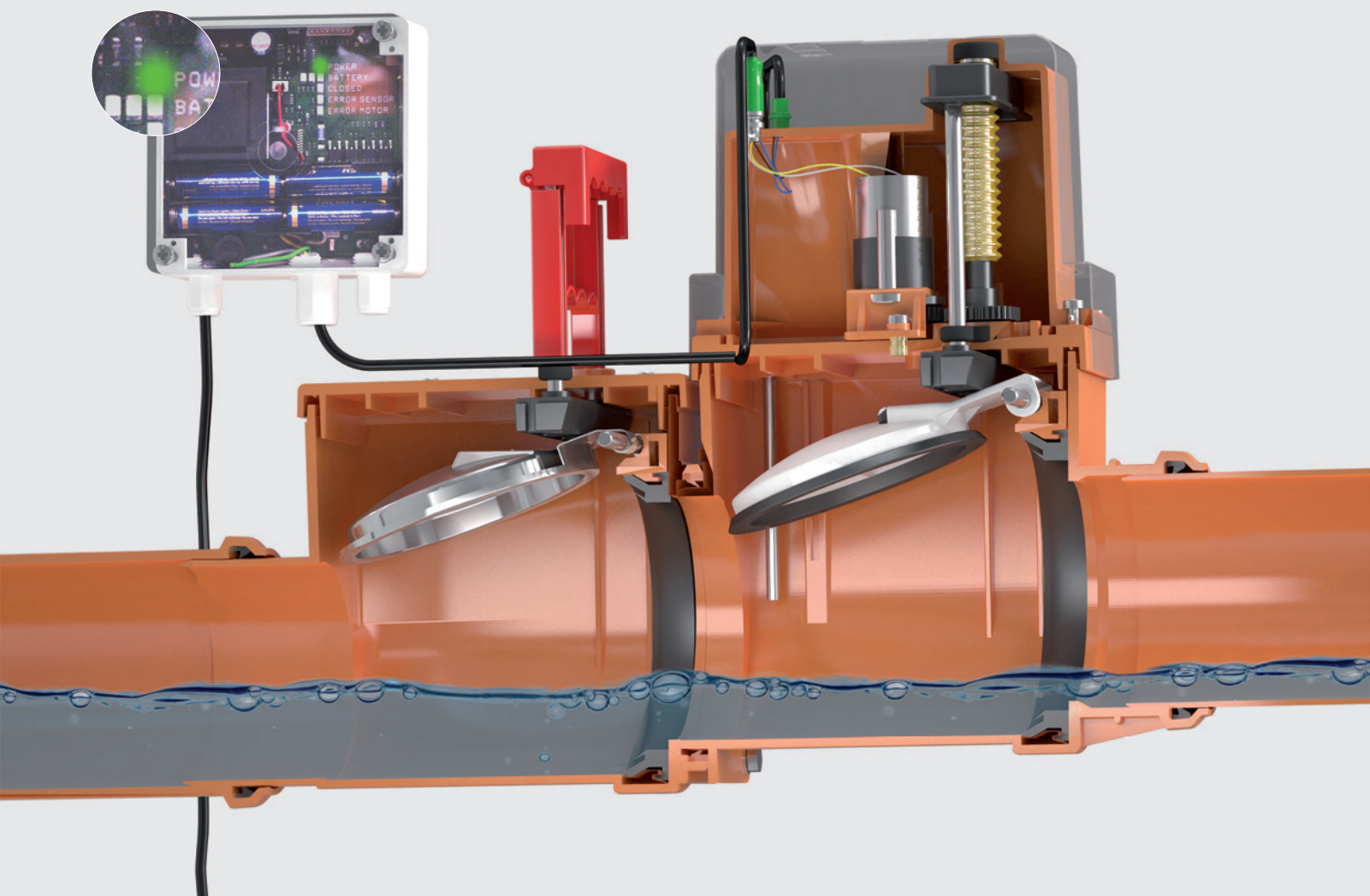

- ① Normal mode
- ② Mode of operation in the case of backflow
- ③ Switching device

Advantages

- The electronics box is protected according to DIN VDE 0470 (IP 65)
- The connecting pipe between the Stausafe and the electronics box is 6 m
- A cover flap that closes automatically in the event of flooding
- Maintenance-friendly housing made from impact-proof ABS plastic
- Closure linkage made from stainless steel
- Emergency power supplied by batteries
- Test pipe connection
- Control electronics in a surface-mounted box
- Optical / acoustic status display, BMS-enabled
- Sealing force: 500 Newton
- Closing time: Approx. 9 seconds

Fields of application for anti-flooding valves

Areas of application and products

Throughout the history of modern sewerage systems, there has been a problem with backflow in public systems. If drainage objects and areas located below the backflow level are connected without safety devices, they will inevitably be subject to damage as a result of backflow situations. And unless adequate insurance is in place, dealing with the aftermath can also prove expensive. Anti-flooding valves used for the purpose of backflow protection must comply with the types specified in table 2 (DIN 1986–100).

Field of application	Types of anti-flooding valves approved for use conforming to DIN EN 13564 or DIN 1986-100	Dallmer anti-flooding valves
Faecal-free wastewater, rainwater	Types 2, 3 and 5	Stausafe RS; Stausafe F; DallSafe 200 anti-flooding utility drain
Faecal wastewater	Type 3 with marking "F"	Stausafe F
Rainwater usage systems	Types 0, 1 and 2	Stausafe RS

Installation requirements

Anti-flooding valves can be used if

- there is sufficient slope to the channel.
- the rooms are of secondary importance, i.e. there is no risk of impairment to key material assets or the health of the occupants.
- there is only a small circle of users, and this circle have access to a WC above the backflow level.
- in the event of backflow, it is possible to cope without the use of the drain point in question.

Planning and installation

The installation location of the Stausafe F must be such that it protects all outlets prone to backflow. If planning a new project, downpipes from upper storeys that are above the backflow level must not be routed via the Stausafe. Anti-flooding valves must be installed in a way that permits both access to functional parts that require maintenance and the execution of functional tests (as per DIN 1986-33).

Please note

Installation of anti-flooding valves must include a 1 m settling section either side of the valve. The Stausafe has a factory-fitted height difference of 31 mm between inlet and drain. The drainage pipe must have a minimum slope of 1%. The anti-flooding valve must be installed so that it is level in both longitudinal and transverse direction.

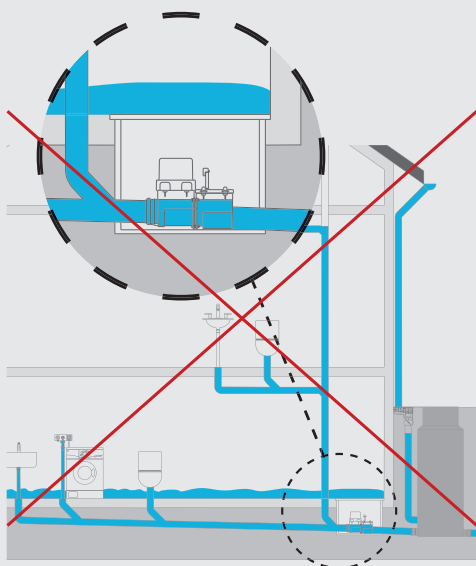

Incorrect

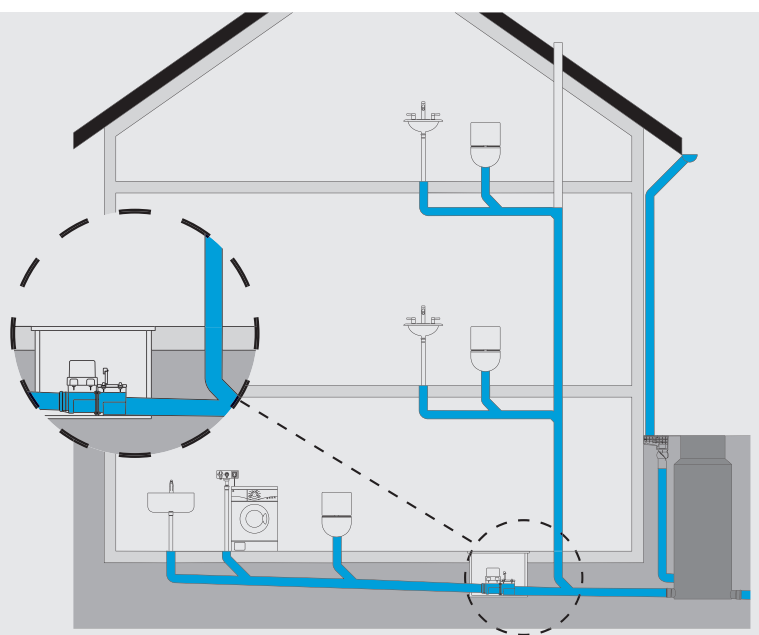

Correct

03

Utility and floor drains

Page 19

Utility and floor drains: Our quality for your safety

Reliable protection and interruption-free drainage

Flooding from heavy rain represents an increasing threat, in particular for spaces in semi-detached houses below the backflow level. After all, no public channel network can easily drain extreme quantities of water; short-term overloads must be calculated in from the outset in the planning stage.

For reliable protection and interruption-free drainage, Dallmer drains with or without anti-flood protection offer optimum solutions for many installation situations. Below the backflow level, the DallSafe 200 / Stone (utility drain conforming to DIN EN 13564 with triple safety device for wastewater that doesn't contain faecal waste) makes it possible to install even level-access showers. Ball valves, anti-flooding flap-valves and manual shut-offs ensure the same triple safety, while the tileable grate delivers custom design. Above the backflow level, if there are no specific requirements for the seal, utility drains without backflow protection as well as the practical PRONTO universal drain can be used.

Discover our utility and floor drains:
dallmer.com/cellar-anti-flooding



What else might interest you: The DallDrain point drains for floor drainage. Installation technicians are provided with an assembly-friendly, highly flexible floor drain for drainage of all sealed surfaces, for example in the bathroom, spa and cellar.

Discover the DallFlex system:
dallmer.com/dallflex



DallSafe
200/1 Stone

Utility drains with anti-flooding valve and sealing option



DallSafe 200/1 K Page 24



DallSafe 200/1 SES Page 24



DallSafe 200/1 Stone Page 24



Cellar drains with anti-flooding valve



Ball seal 110 Page 24

Cellar drains



Utility drain 57 Page 26



Utility drain 61 Page 26



Utility drain 71 Page 26

Floor drains



PRONTO

Page 28



PRONTO K

Page 28



PRONTO Primus

Page 28

Utility drains with anti-flooding valve and sealing option

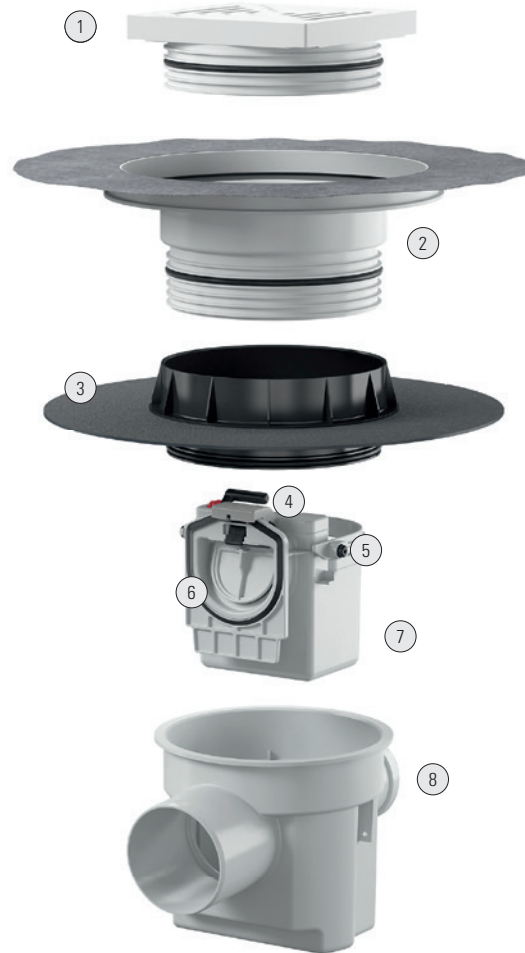

Variants



DallSafe 200/1 K with plastic grate and sludge trap



DallSafe 200/1 SES with stainless steel grate and sludge trap



DallSafe 200/1 Stone with stainless steel grate for tiling



110/3 with three-sided connection option, DN 70 inflow

Material	Drain body and frame made from polypropylene, grate made from polyamide, ABS or stainless steel*
Grate dimensions	200 × 200 mm (DallSafe), 255 × 185 mm (ball seal)
Build-in height	24 – 290 mm*
Load class	K 3 (300 kg)
Flow rate	1.59 l/s (DallSafe), 1.62 l/s (ball seal)

*Depending on the version



- ① Grates are height-adjustable, 24 – 120 mm
- ② Raising piece with sealing sleeve for seals conforming to DIN 18534, for insulation and screed, 120 – 290 mm
- ③ Sealing set for the connection of bituminous sealing against ground moisture
- ④ Manual shut-off
- ⑤ Self-inflating ball valve
- ⑥ Self-aligning cover flap
- ⑦ The trap
- ⑧ Feed DN 70 for connecting washing machine and sink

Advantages of DallSafe

The flexible solution for utility spaces: DallSafe K with plastic grate and sludge trap, DallSafe SES with stainless steel grate and sludge trap as well as DallSafe Stone with stainless steel grate for tiling can even be used in level-access showers, thanks to their sealing option. (Ball seal 110 is a suitable option where there are no particular requirements for the seal.)

- Type 5 tested acc. to EN 13564, for faecal-free wastewater
- Threefold safety thanks to ball valve, anti-flooding flap-valve and manual shut-off
- Housing made of highly impact-resistant polypropylene, which can be installed directly in the raw concrete surface
- Flexible installation depth 224 – 560 mm
- Grate swivels for optimum adaptation to tile pattern
- Test pipe connection
- Tool-free removal of backflow unit and trap insert
- Easy cleaning
- Complies with the requirements of DIN EN 1253

Product information:
dallmer.com/cellar-anti-flooding





Variants



61 AK with vertical outlet



57 AK with side outlet



71 without inlet connection



71/3 with DN 70 inlet connection

Material	Drain body and frame made from polypropylene, highly impact-resistant Grate made from polyamide, ABS or stainless steel*
Dimensions	200 × 200 mm (DallSafe), 255 × 185 mm (ball seal)
Load class	K 3 (300 kg)
Flow rate	1.47 l/s – 2.7 l/s*
Sealing water height	50 – 60 mm*

*Depending on the version



- ① Polyamide cover plate
- ② Hair sieve
- ③ Height-adjustable grate
- ④ Removable bell-type trap insert

Advantages

You're sure to find the right utility drain for any utility space: The highest flow rate for utility drain 71 with DN 100 outlet, with additional DN 50 (version 71/1) and DN 70 (version 71/3) inlet connections. Variable rotatable grate for 57/61 utility drains.

- Drain body with removable bell-type trap insert (61 AK)
- Hair sieve (57/61 AK) / sludge catcher (71)
- Rotatable and height-adjustable grate (57/61 AK)

Product information:
dallmer.com/cellar-drains





Variants



PRONTO



PRONTO K



PRONTO Primus

Material	Highly impact-resistant outlets made of polypropylene, with moulded lip seals made of TPE Frame made of stainless steel or polypropylene, grate made of stainless steel or aluminium*
Frame dimensions	120 × 120 mm
Load class	K 3 (300 kg)
Flow rate	0.4 – 0.8 l/s*

*Depending on the version



- ① Frame made of stainless steel
- ② Trap insert and rodding eye
- ③ Lip seal

Advantages

Floor drain for universal use in outdoor areas, gardens and utility spaces. Anywhere where there is no special waterproofing membrane specification, the PRONTO trap insert is a quick and cost-effective solution. Simply cut the pipe flush with the floor and insert the trap. Fitted with strong lip seals, the drain body is height adjustable up to 75 mm. The Primus design with sealing water and mechanically effective block is ideal for applications with irregular use.

- Trap insert and rodding eye, sealing water height 50 mm
- Universal lip seal

Product information:
dallmer.com/pronto



04

Product range

Page 31

Anti-flooding valves Stausafe

DALLMER anti-flooding valve Stausafe E

for use with rain water systems

SPECIFICATION

- self-closing stainless steel flap
- stainless steel pivots
- easy to maintain ABS housing
- inspection cover with wingnuts can be opened for maintenance without tools

ITEM	DN	PART NO.
anti-flooding valve Stausafe E	DN 100	661067
anti-flooding valve Stausafe E	DN 125	661081
anti-flooding valve Stausafe E	DN 150	661098
anti-flooding valve Stausafe E	DN 200	660008



anti-flooding valve Stausafe E

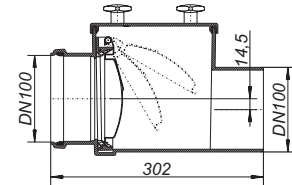

DALLMER anti-flooding valve Stausafe H

for use with rain water systems

SPECIFICATION

- self-closing stainless steel flap
- manually operated lock
- stainless steel pivots
- easy to maintain ABS housing
- inspection cover with wingnuts can be opened for maintenance without tools

ITEM	DN	PART NO.
anti-flooding valve Stausafe H	DN 100	661166
anti-flooding valve Stausafe H	DN 125	661180
anti-flooding valve Stausafe H	DN 150	661197
anti-flooding valve Stausafe H	DN 200	660107



anti-flooding valve Stausafe H

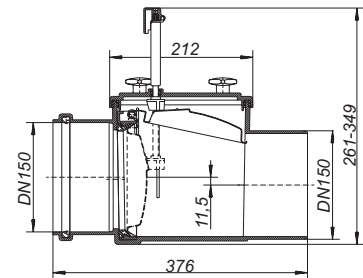

DALLMER anti-flooding valve Stausafe RS

for EN 13564-1:2002 (DN 100-DN 150), type 2 operation conforms to DIN 1986-100:2002-03.

SPECIFICATION

- twin self-closing stainless steel flaps
- manually operated lock
- stainless steel pivots
- test-port
- easy to maintain ABS housing
- inspection cover with wingnuts can be opened for maintenance without tools

ITEM	DN	PART NO.
anti-flooding valve Stausafe RS	DN 100	661265
anti-flooding valve Stausafe RS	DN 125	661289
anti-flooding valve Stausafe RS	DN 150	661296
anti-flooding valve Stausafe RS	DN 200	660206



anti-flooding valve Stausafe RS

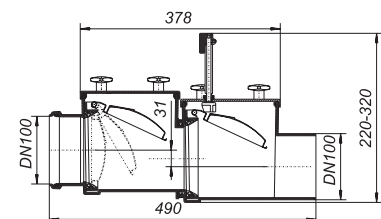

Note: Local regulations outside Germany may allow use on sewage lines.
eg. Document H of the UK Building Regulations.

Anti-flooding valves Stausafe

DALLMER anti-flooding conversion kit Stausafe RS in F

complete kit incl. electronic controls and cables to convert an anti-flooding valve type Stausafe RS to type Stausafe F for use with faecal waste water.

ITEM	DN	PART NO.
anti-flooding conversion kit Stausafe RS in F	DN 100/DN 125	664402
anti-flooding conversion kit Stausafe RS in F	DN 150	664426



anti-flooding conversion kit Stausafe RS in F

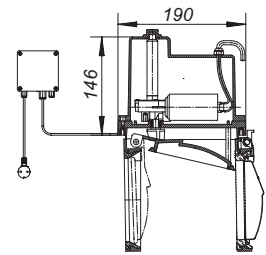

DALLMER anti-flooding valve Stausafe F

according to EN 13564 type 3 (F)
operation conforms to DIN 1986-100:2002-03 for use with faecal waste water.

SPECIFICATION

- electronic flood sensor
- flap with electrically operated lock
- secondary stainless steel flap with manual lock
- stainless steel pivots
- sealed compartment for motor
- emergency power by batteries
- test-port
- easy-to-install ABS housing
- inspection cover with wingnuts can be opened for maintenance without tools
- electronic controls in box for on-wall mounting with warning lamp/buzzer can be used with central building control systems.

flaps: 316L stainless steel/HDPE

power supply: 230 V/0,5 A

connection cable: 6 m, PUR, 5 x 0.75 mm²

motor supply: 12 V low voltage

emergency power: batteries, max. 6 days

sensor: coaxial electrode

sealing force: 500 newtons

closing time: approx 9 seconds

ITEM	DN	PART NO.
anti-flooding valve Stausafe F	DN 100	661562
anti-flooding valve Stausafe F	DN 125	661586
anti-flooding valve Stausafe F	DN 150	661593

The motorized flap and its related components can be supplied separately, to convert a type RS valve to type F specification, parts 664402/664426.

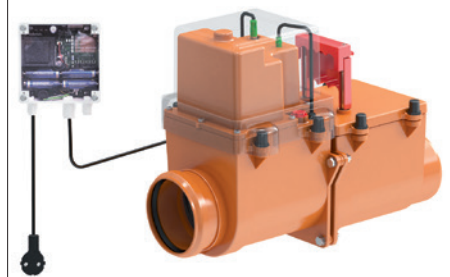

anti-flooding valve Stausafe F

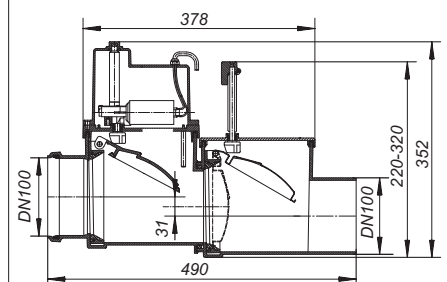

Dimension tables Anti-flooding valves Stausafe

Stausafe F

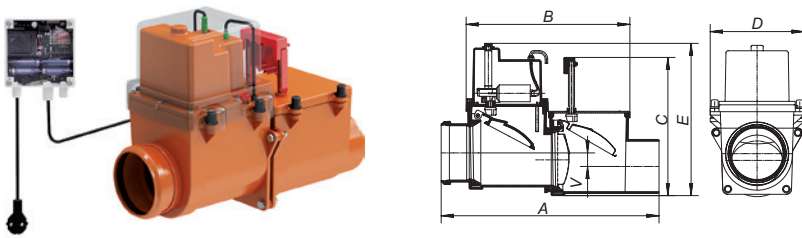

DN	A (mm)	B (mm)	C (mm)	D (mm)	E (mm)	V (mm)
DN 70	490	378	220 – 320	217	352	31
DN 100	503	378	220 – 320	217	352	31
DN 125	590	425	261 – 349	253	371	23

Stausafe E/H

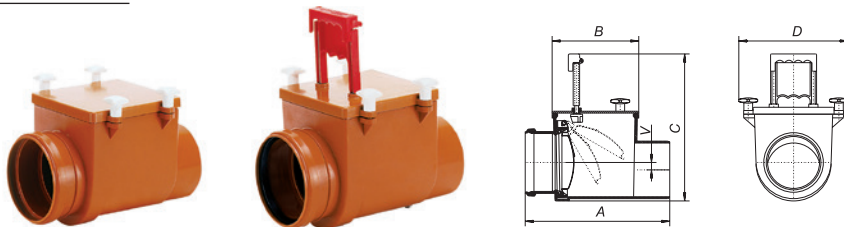

Stausafe E

Stausafe H

DN	A (mm)	B (mm)	C (mm)	D (mm)	V (mm)
DN 100	302	185	220 – 320	240	14,5
DN 125	315	185	220 – 320	240	16,5
DN 150	376	212	261 – 349	274	11,5
DN 200	445	165	248 – 348	258	20,0

Stausafe RS

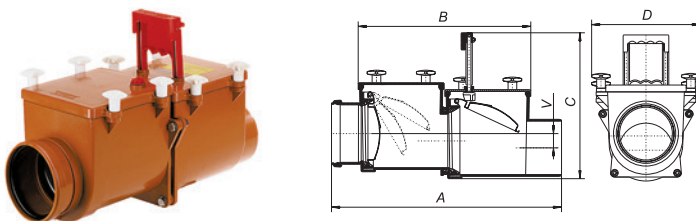

DN	A (mm)	B (mm)	C (mm)	D (mm)	V (mm)
DN 100	490	378	220 – 320	240	31
DN 125	503	378	220 – 320	240	31
DN 150	590	425	261 – 349	274	23
DN 200	615	335	248 – 348	258	40

Non-return valves

DALLMER non-return valve RS 4

vertical or horizontal installation
with rising ball seal.

MATERIAL

body polypropylene

- ▶ non-return valve RS 4.5
with two cleaning eyes
- ▶ non-return valve RS 4.7
with one cleaning eye

ITEM	DN	PART NO.
non-return valve RS 4.5	DN 50	840028
non-return valve RS 4.7	DN 70	840042

RS 4 non-return valves give a practical solution to back-flow in "problem" installations.

The rising-ball mechanism prevents water flowing back into baths or showers.

Type RS 4 non-return valves are used to prevent back-flow in pipework, but should not be regarded as anti-flooding valves conforming to DIN 1997. These non-return valves are not permitted to be installed instead of anti-flooding valves below flood level.



non-return valve RS 4.5

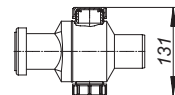
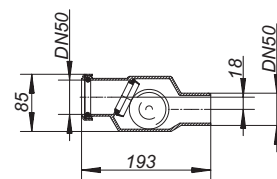

non-return valve RS 4.7

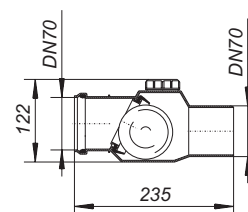

Utility drains with anti-flooding

DALLMER anti-flooding drain DallSafe 200/1

conforming to DIN EN 1253

for EN 13564 type 5, operation conforms to DIN 1986-100:2002-03 for use with grey waste water outlet DN 100 horizontal (3 degrees fall).

SPECIFICATION

- automatic rising ball
- flap-valve on outlet
- manual lock
- trap insert, 50 mm water seal (conforming to DIN EN 1253)
- tool-free removal of trap insert
- test-port
- DN 70 side inlet
- temporary blanking plate
- grate height adjustable 24 – 120 mm

MATERIAL

body polypropylene

- ▶ **anti-flooding drain DallSafe 200/1 Stone**
anti-flooding drain with stainless steel grate, can be tiled individually, grate 304 stainless steel, 200 x 200 mm
- ▶ **anti-flooding drain DallSafe 200/1 SES**
anti-flooding drain with stainless steel grate.
frame 304 stainless steel, 200 x 200 mm, grate 5 mm 316L stainless steel, secured, load class K 3 (300 kg)
- ▶ **anti-flooding drain DallSafe 200/1 K**
anti-flooding drain with polyamide grate.
frame ABS, 200 x 200 mm, grate polyamide, load class K 3 (300 kg)

FLOW RATE TESTED TO DIN EN 1253 (with 20 mm water over grate)

	Required	Dallmer
DN 100	1.4 l/s	1.59 l/s

ITEM	DN	DIMENSION	PART NO.
anti-flooding drain DallSafe 200/1 Stone	DN 100	200 x 200 mm	720221
anti-flooding drain DallSafe 200/1 SES	DN 100	200 x 200 mm	720214
anti-flooding drain DallSafe 200/1 K	DN 100	200 x 200 mm	720207



anti-flooding drain DallSafe 200/1 Stone

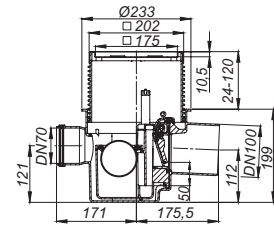

anti-flooding drain DallSafe 200/1 SES

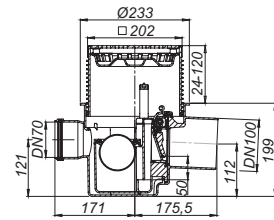

anti-flooding drain DallSafe 200/1 K

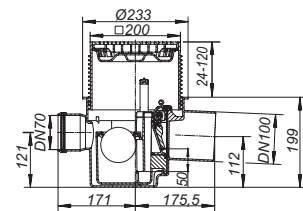

DALLMER safety clamp DallSafe 200

Optional accessory for the additional fixing of grates, raising pieces and grate extensions in the DallSafe anti-flooding cellar drains, if they are to be set in concrete.

ITEM	PART NO.
safety clamp DallSafe 200	720276



safety clamp DallSafe 200

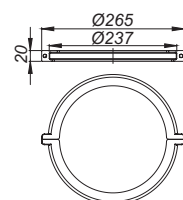

Utility drains with anti-flooding

DALLMER raising piece type DallSafe 200
used with type DallSafe 200 anti-flooding drain

SPECIFICATION

- flexible sealing collar for secure bonding of under-tile waterproofing conforming to DIN 18534
- back flow seal
- temporary blanking plate
- height adjustable 70 – 240 mm

MATERIAL

polypropylene

ITEM	DIMENSION	PART NO.
raising piece type DallSafe 200	d: 495 mm	720245



raising piece type DallSafe 200

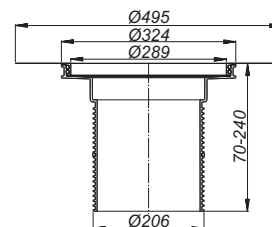

DALLMER sealing kit type DallSafe 200
used with type DallSafe 200 anti-flooding drain

SPECIFICATION

- sealing kit to connect bituminous waterproofing against ground moisture
- back flow seal
- temporary blanking plate

MATERIAL

ABS

ITEM	DIMENSION	PART NO.
sealing kit type DallSafe 200	d: 450 mm	720252



sealing kit type DallSafe 200

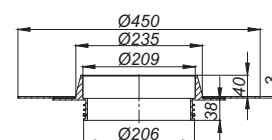

DALLMER extension type DallSafe 200
used with type DallSafe 200 anti-flooding drain

SPECIFICATION

- back flow seal
- temporary blanking plate
- height adjustable 47 – 200 mm

MATERIAL

polypropylene

ITEM	DIMENSION	PART NO.
extension type DallSafe 200	d: 210 mm	720238



extension type DallSafe 200

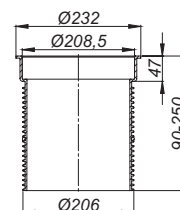

DALLMER rising ball assembly DallSafe 200

spare part for anti-flooding drain DallSafe 200 with rising ball valve, flap-valve, manually operated lock, trap insert with 50 mm water seal.

MATERIAL

polypropylene

ITEM	PART NO.
rising ball assembly DallSafe 200	725011



rising ball assembly DallSafe 200

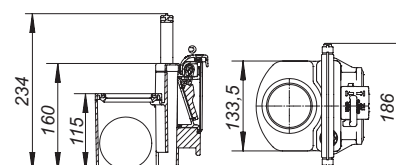

Utility drains with anti-flooding

DALLMER anti-flooding drain Ballstau 110

for EN 13564 type 5, operation conforms to DIN 1986-100:2002-03 for use with grey waste water outlet DN 100 horizontal (3 degrees fall).

SPECIFICATION

- automatic rising ball
- flap-valve on outlet
- manual lock
- replaceable rising ball assembly
- test-port

MATERIAL

body ABS
grate ABS, 2-piece, load class K 3 (300 kg)

- ▶ anti-flooding drain Ballstau 110/1 with DN 50 side inlet
- ▶ anti-flooding drain Ballstau 110/3 with DN 70 side inlet and two DN 70 bosses for alternative side inlet location

FLOW RATE TESTED TO DIN EN 1253 (with 20 mm water over grate)

	Required	Dallmer
DN 100	1.4 l/s	1.62 l/s

ITEM

ITEM	DN	PART NO.
anti-flooding drain Ballstau 110	DN 100	720061
anti-flooding drain Ballstau 110/1	DN 100	720160
anti-flooding drain Ballstau 110/3	DN 100	720368



anti-flooding drain Ballstau 110

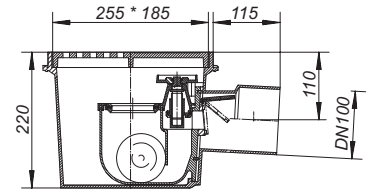

anti-flooding drain Ballstau 110/1

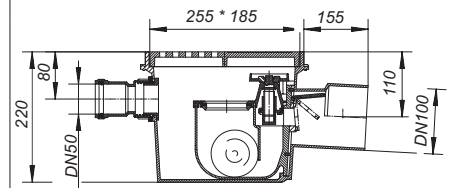

anti-flooding drain Ballstau 110/3

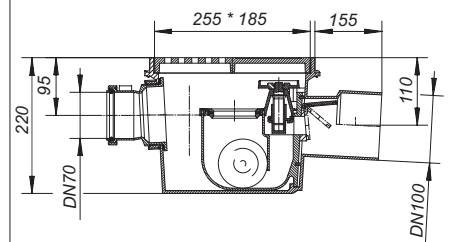

Utility drains without anti-flooding

DALLMER utility drain type 57

conforming to DIN EN 1253
outlet horizontal (3 degrees fall).

SPECIFICATION

- trap insert, 60 mm water seal (conforming to DIN EN 1253)
- height adjustable grate
- hair sieve

MATERIAL

body polypropylene
frame polypropylene, 150 x 150 mm

- ▶ **utility drain type 57 AK**
grate polyamide, load class K 3 (300 kg)
- ▶ **utility drain type 57 AKE**
grate stainless steel, load class K 3 (300 kg)

FLOW RATE TESTED TO DIN EN 1253 (with 20 mm water over grate)

	Required	Dallmer
DN 70	0.8 l/s	1.47 l/s
DN 100	1.4 l/s	1.67 l/s

ITEM	DN	PART NO.
utility drain type 57 AK	DN 70	570840
utility drain type 57 AK	DN 100	570864
utility drain type 57 AKE	DN 70	578945
utility drain type 57 AK	DN 100	578969

DN 70 connects to BS4514 75 mm pipework with 880345 adaptor.



utility drain type 57 AK

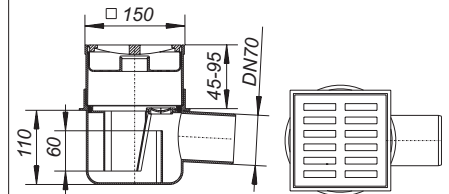

recess size: 240 x 370 mm

Utility drains without anti-flooding

DALLMER utility drain type 61 AK

conforming to DIN EN 1253
outlet DN 100 vertical.

SPECIFICATION

- trap insert, 50 mm water seal (conforming to DIN EN 1253)
- height adjustable grate
- hair sieve

MATERIAL

polypropylene
grate polyamide, load class K 3 (300 kg), frame polypropylene, 150 x 150 mm

FLOW RATE TESTED TO DIN EN 1253 (with 20 mm water over grate)

	Required	Dallmer
DN 100	1.4 l/s	1.70 l/s

ITEM	DN	PART NO.
utility drain type 61 AK	DN 100	610867



utility drain type 61 AK

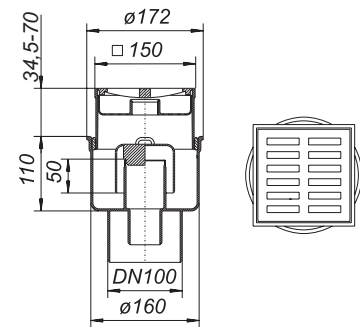

DALLMER floor drain type 60

outlet DN 50 vertical
with bell trap, 25 mm water seal.

MATERIAL

polypropylene
frame polypropylene, 100 x 100 mm, grate polyamide, incorporating bell trap

FLOW RATE TESTED TO DIN EN 1253 TAB. 3, (with 20 mm water over grate), conforming to DIN EN 274

	Required	Dallmer
DN 50	0.4 l/s	0.6 l/s

ITEM	DN	DIMENSION	PART NO.
floor drain type 60	DN 50	100 x 100 mm	600509



floor drain type 60

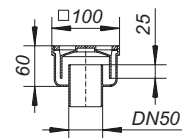

No flange for water-proofing membranes.

Utility drains without anti-flooding

DALLMER utility drain type 71

conforming to DIN EN 1253
outlet DN 100 horizontal (3 degrees fall).

SPECIFICATION

- trap insert, 60 mm water seal (conforming to DIN EN 1253)
- bucket

MATERIAL

polypropylene
frame polypropylene, 170 x 240 mm, grate ABS, load class K 3 (300 kg)

- ▶ utility drain type 71/1, DN 50 side inlet
with DN 50 side inlet
- ▶ utility drain type 71/3, DN 70 side inlet
with DN 70 side inlet and DN 70 bosses in 2 alternative positions

FLOW RATE TESTED TO DIN EN 1253 (with 20 mm water over grate)

	Required	Dallmer
DN 100	1.4 l/s	2.7 l/s
DN 100, DN 50 side inlet	1.4 l/s	2.2 l/s
DN 100, DN 70 side inlet	1.4 l/s	2.2 l/s

ITEM	DN	PART NO.
utility drain type 71	DN 100	710062
utility drain type 71/1, DN 50 side inlet	DN 100	710161
utility drain type 71/3, DN 70 side inlet	DN 100	710369



utility drain type 71

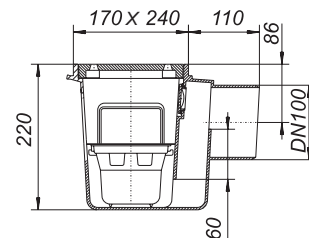

utility drain type 71/1

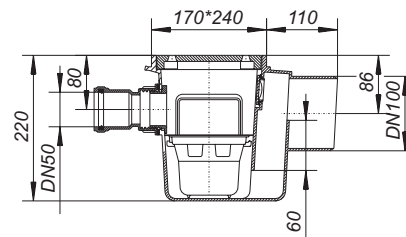

utility drain type 71/3

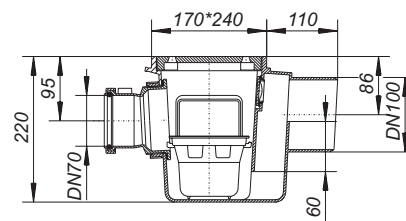

Accessories for utility drains

DALLMER grate for utility drain 71

used with type 71 utility drain

- ▶ **grate for utility drain 71, grey**
ABS, grey, 225 x 155 mm, load class K 3 (300 kg)
- ▶ **grate for utility drain 71, white**
ABS, white, 225 x 155 mm, load class K 3 (300 kg)
- ▶ **grate for utility drain 71, cast iron**
cast iron, 225 x 155 mm, load class L 15 (1.5 t)

ITEM	DIMENSION	PART NO.
grate for utility drain 71, grey	225 x 155 mm	714923
grate for utility drain 71, white	225 x 155 mm	714930
grate for utility drain 71, cast iron	225 x 155 mm	714947



grate for utility drain 71, grey

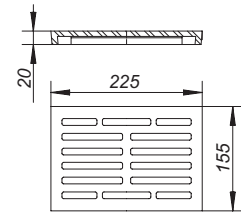

DALLMER grate for Ballstau 110

used with type Ballstau 110 drain

- ▶ **grate for Ballstau 110, grey**
two-part, ABS grey, 250 x 180 mm, load class K 3 (300 kg)
- ▶ **grate for Ballstau 110, stainless steel**
one-part, stainless steel, 250 x 180 mm, load class K 3 (300 kg)

ITEM	DIMENSION	PART NO.
grate for Ballstau 110, grey	250 x 180 mm	724922
grate for Ballstau 110, stainless steel	250 x 180 mm	724762



grate for Ballstau 110, grey

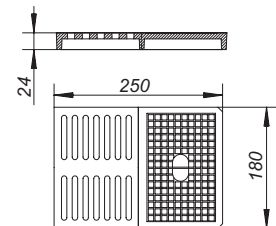

DALLMER extension for utility drain 71

used with type 71 utility drain, can be cut to correct height on site

MATERIAL
ABS, grey

ITEM	DIMENSION	PART NO.
extension for utility drain 71	100 mm	714954



extension for utility drain 71

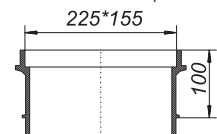

DALLMER extension for Ballstau 110

used with type 110 Ballstau drain, can be cut to correct height on site

MATERIAL
ABS, grey

ITEM	DIMENSION	PART NO.
extension for Ballstau 110	100 mm	724953



extension for Ballstau 110

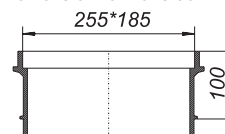

PRONTO utility drain

DALLMER floor drain PRONTO

pushes into a pipe, for floor constructions without a waterproofing membrane.

SPECIFICATION

- trap insert removable for cleaning, 50 mm water seal
- flexible sealing ribs

MATERIAL

polypropylene/rubber/TPE
 frame 304 stainless steel, 120 x 120 mm
 grate 304 stainless steel, 115 x 115 mm, load class K 3 (300 kg)

FLOW RATE TESTED TO DIN EN 1253 TAB. 3, (with 20 mm water over grate)

	Required	Dallmer
DN 90	0.8 l/s	0.8 l/s
DN 100	1.4 l/s	0.8 l/s
DN 125	2.8 l/s	0.8 l/s

ITEM	DN	DIMENSION	PART NO.
floor drain PRONTO	DN 90/DN 100	120 x 120 mm	700063
floor drain PRONTO	DN 125	120 x 120 mm	700087

The trap assembly can be easily removed and the fitting used for rodding access.



floor drain PRONTO

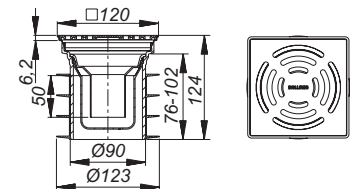

DALLMER floor drain PRONTO K

pushes into a pipe, for floor constructions without a waterproofing membrane

SPECIFICATION

- trap insert removable for cleaning, 50 mm water seal
- flexible sealing ribs

MATERIAL

polypropylene/rubber/TPE
 frame polypropylene, 120 x 120 mm

- ▶ floor drain PRONTO K
 grate 304 stainless steel, 115 x 115 mm, load class K 3 (300 kg)
- ▶ floor drain PRONTO K, secured
 grate 304 stainless steel, 115 x 115 mm, secured, class K 3 (300 kg)
- ▶ floor drain PRONTO K Alu
 grate aluminium

FLOW RATE TESTED TO DIN EN 1253 TAB. 3, (with 20 mm water over grate)

	Required	Dallmer
DN 90	0.8 l/s	0.8 l/s
DN 100	1.4 l/s	0.8 l/s
DN 125	2.8 l/s	0.8 l/s

ITEM	DN	DIMENSION	PART NO.
floor drain PRONTO K	DN 90/DN 100	120 x 120 mm	700360
floor drain PRONTO K, secured	DN 90/DN 100	120 x 120 mm	700391
floor drain PRONTO K	DN 125	120 x 120 mm	700384
floor drain PRONTO K Alu	DN 90/DN 100	120 x 120 mm	700339



floor drain PRONTO K

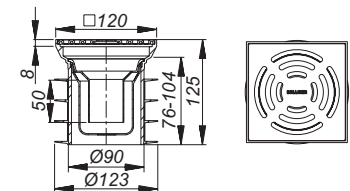

floor drain PRONTO K Alu

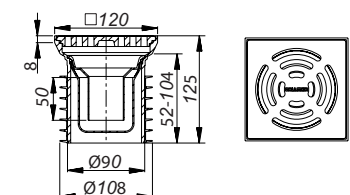

PRONTO utility drain

DALLMER floor drain PRONTO Primus

pushes into a DN 100 pipe, for floor constructions without a waterproofing membrane.

SPECIFICATION

- removable Primus trap insert, using a floating bell, which sinks to seal the trap if water evaporates
- flexible sealing ribs

MATERIAL

polypropylene/rubber/TPE

frame 304 stainless steel, 120 x 120 mm

grate 304 stainless steel, 115 x 115 mm, load class K 3 (300 kg)

The Primus system:



with water,
it's a bell-trap

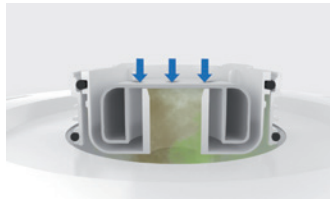

without water
the bell sinks to seal the pipe

FLOW RATE TESTED TO DIN EN 1253 TAB. 3,
(with 20 mm water over grate)

	Required	Dallmer
DN 100	1.4 l/s	0.4 l/s

ITEM	DN	DIMENSION	PART NO.
floor drain PRONTO Primus	DN 100	120 x 120 mm	700032



floor drain PRONTO Primus

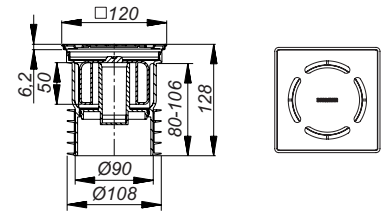

Service

Our products at a glance

Help for planning and installation

Discover our diverse drainage systems and get an overview of our product categories on our website dallmer.com

Planners, architects and installation technicians can visit dallmer.com/service for useful tools and documents which provide them with support during the entire process, from planning to installation.



Installation instructions



DXF drawings



Data sheets



BIM – building information modelling



System sections



Configurator

The Dallmer Sessions online. video. live.



If you are abreast of the state-of-the-art of drainage technologies, changes to standards and directives, and current bathroom trends, you have a clear advantage which you can pass on to your customers. Dallmer's training opportunities now make it even easier to keep up to date.

For more information and current scheduled events, visit dallmer.com/sessions

10-year warranty*

A promise which we are happy for you to pass on to your customers.

DallmerVideos [dallmer.official](https://www.facebook.com/dallmer.official) [dallmer_official](https://www.instagram.com/dallmer_official) [dallmer_official](https://www.pinterest.com/dallmer_official)

*Warranty conditions from January 2013: Republic of Ireland and United Kingdom excluded.

Dallmer GmbH + Co. KG
Wiebelsheidestraße 25
59757 Arnsberg
Germany

T +49 2932 9616-0
F +49 2932 9616-222
E info@dallmer.de
W dallmer.com

DW20075 / 10/2023_PDF
WEEE-Reg.-Nr. DE 98946358

