

washing machine or dishwasher trap type 406.2, DN 40/DN 50

Part number: 130709

GTIN: 4001636130709

Rebate group: 1

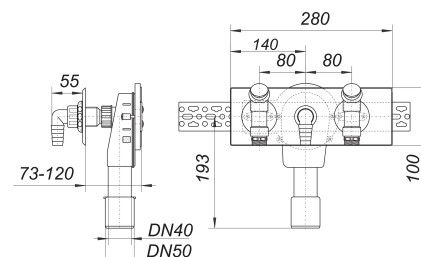

Description:

washing machine or dishwasher trap type 406.2, DN 40/DN 50

specification:

- compact recessed body
- backing plate
- original Leifeld fixing bracket
- gunmetal wall plate elbow
- original 1/2" SCHELL on/off valve COMFORT with backflow preventer and air admittance valve
- inlet hose connector, chrome
- recess depth 73 - 120 mm
- spacer
- blanking plug

material:

polyethylene trap-body for welding HDPE

Tested by:

DVGW (on/off valve)

for horizontal installation, with 2 on/off valves e.g. hot and cold feeds, cover plate stainless steel, 280 x 100 mm

Spare parts: