

Contents

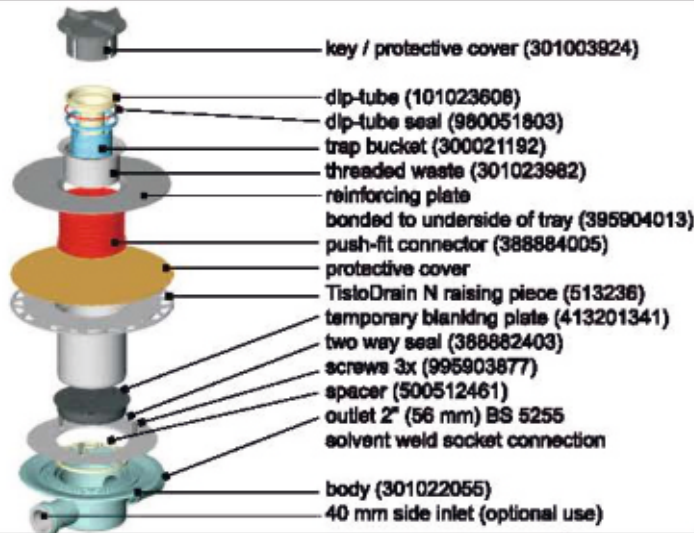

Installation dimensions

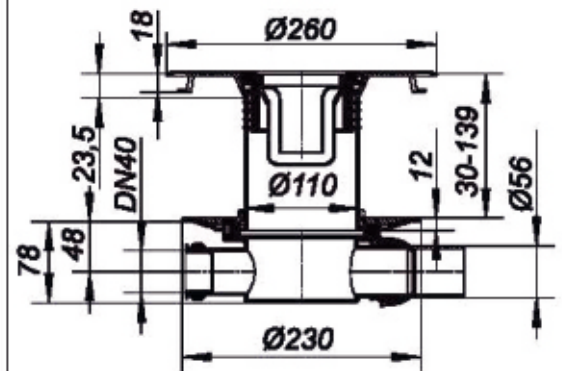

Installation in concrete floor

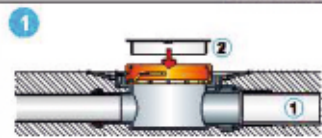

- 1 fit the drain body with the two way seal and spacer into the floor and connect to the pipework.
- 2 fit the blanking plate over the opening.

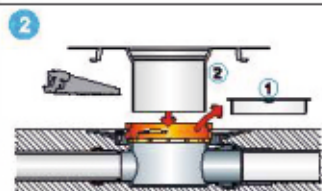

- 1 remove the blanking plate.
- 2 fit the TistoDrain raising piece, shortening the connector as required!

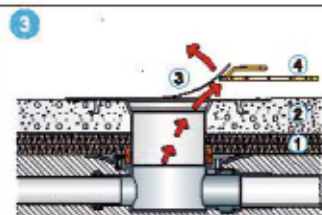

- 1 install the thermal insulation / sound insulation
- 2 lay the screed
- 3 remove the protective cover
- 4 remove the spacer

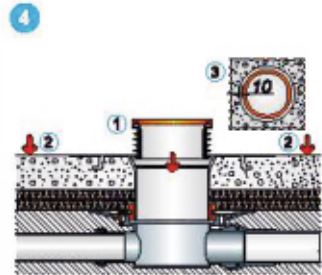

- 1 fit the push-fit connector into the raising piece.
- 2 apply the under-tile waterproofing
- 3 **Attention:** don't apply the screed till the push-fit connector, distance ca. 10 mm (s. Drawing)

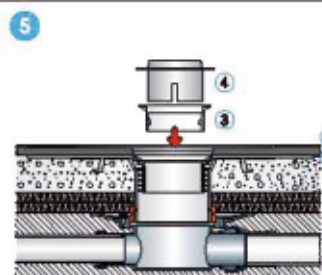

- 1 under-tile waterproofing
- 2 one-piece stone shower tray with reinforcing plate
- 3 screw the threaded waste with the push-fit connector together.
- 4 using the protective cover as a key, tighten.

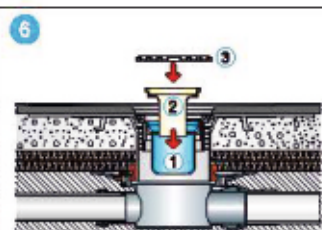

- 1 fit the trap bucket into the threaded waste.
- 2 fit the dip-tube with dip-tube seal into the trap bucket and press firmly.
- 3 insert the grate (accessories)

Installation in timber floor

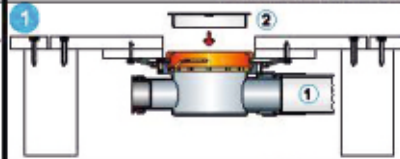

- 1 fit the drain body with the two way seal and spacer under the timber floor and connect to the pipework.
- 2 fit the blanking plate over the opening.

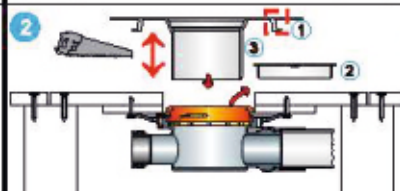

- 1 eg for installation
- 2 remove the blanking plate.
- 3 fit the TistoDrain raising piece, shortening the connector as required!

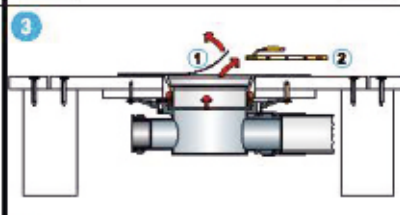

- 1 remove the protective cover
- 2 remove the spacer

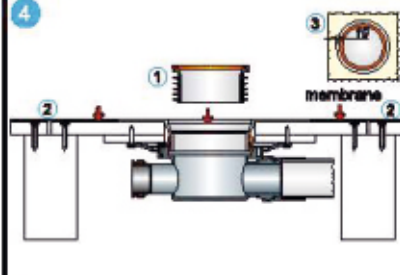

- 1 fit the push-fit connector into the raising piece.
- 2 apply the under-tile waterproofing
- 3 **Attention:** don't apply the screed till the push-fit connector, distance ca. 10 mm (s. Drawing)

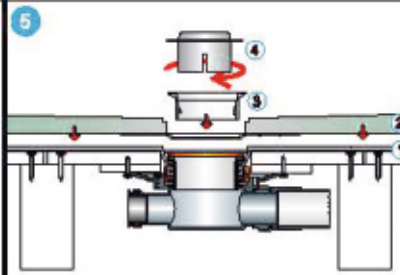

- 1 under-tile waterproofing
- 2 one-piece stone shower tray with reinforcing plate
- 3 screw the threaded waste with the push-fit connector together.
- 4 using the protective cover as a key, tighten.

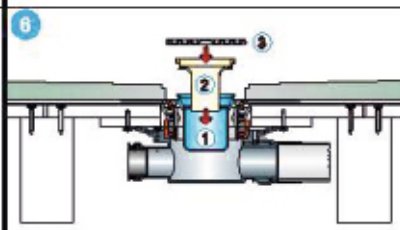

- 1 fit the trap bucket into the threaded waste.
- 2 fit the dip-tube with dip-tube seal into the trap bucket and press firmly.
- 3 insert the grate (accessories)

1

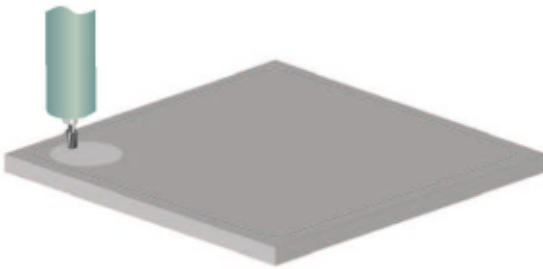

Fall construction:
depend from the surface condition
of the stone material min. 1,5 - 2 %

2

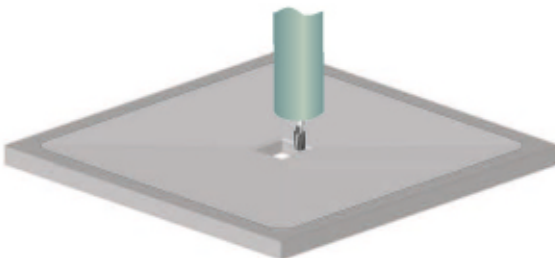

Make the opening:
with milling surface or for shims.
See index (page 3) for the two
processing options and the
different grate dimensions.

3

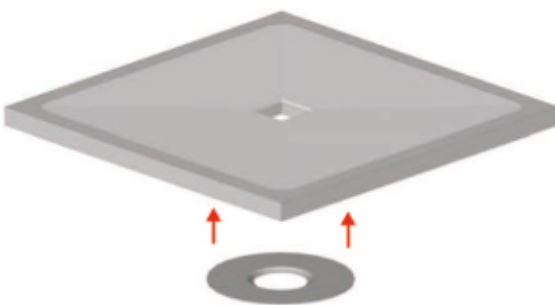

Fit the reinforce plate:
holohedral glue of the reinforce
plate with the shower tray, central
to the opening. Select suitable glue
depending on the stone art. The
reinforce plate warranted the
secure and sealing connection of
the drain body.

accessories/shim kits

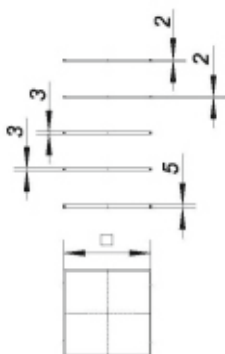

shim kit 145 x 145 mm
Part number 495600
shim kit 120 x 120 mm
Part number 495617

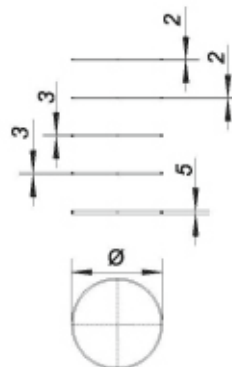

shim kit Ø 145 mm
Part number 495631
shim kit Ø 120 mm
Part number 495624

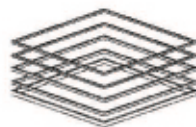

Dimension Index



Machine processing one-piece natural stone shower trays

1. Aperture with milling grate receiver

square grates

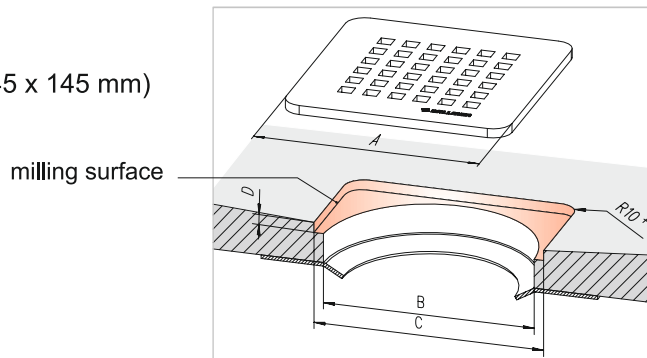
(120 x 120 mm and 145 x 145 mm)



 square grate, 120 r 10		
A	120 x 120 mm	
B	Ø 112 mm	+1/-0
C	121 x 121 mm	+1/-0
D	5,2 mm	+ - 0,1
 square grate, 145 r 10		
A	145 x 145 mm	
B	Ø 112 mm	+1/-0
C	146 x 146 mm	+1/-0
D	5,2 mm	+ - 0,1

round grates

(Ø 120 mm and Ø 145 mm)

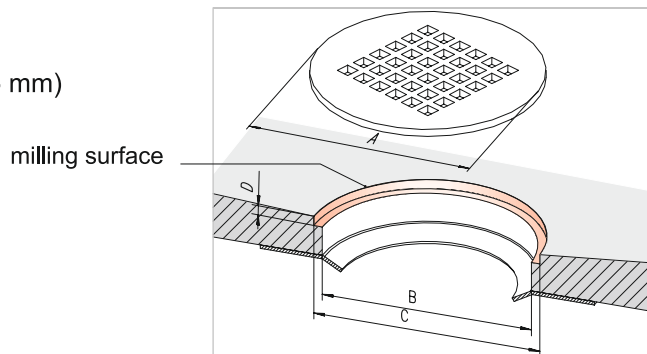

 round grate, Quadra Ø 120		
A	Ø 120 mm	
B	Ø 112 mm	+1/-0
C	Ø 121 mm	+1/-0
D	5,2 mm	+ - 0,1
 round grate, Astra 145		
A	Ø 145	
B	Ø 112 mm	+1/-0
C	Ø 146 mm	+1/-0
D	5,2 mm	+ - 0,1



2. Aperture with shims as grate receiver

square grates

(120 x 120 mm and 145 x 145 mm)

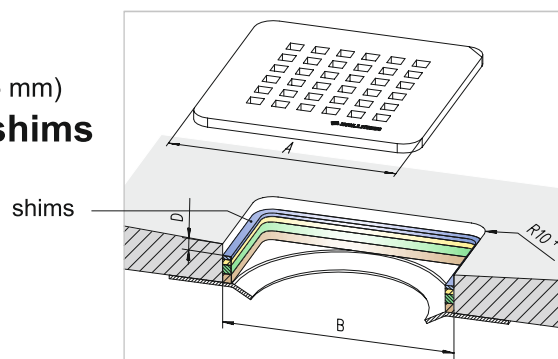
- installation with shims



 square grate, 120 r 10		
A	120 x 120 mm	
B	121 x 121 mm	+1/-0
D	5,0 mm	+1/-0
 square grate, 145 r 10		
A	145 x 145 mm	
B	146 x 146 mm	+1/-0
D	5,0 mm	+1/-0

round grates

(Ø 120 mm and Ø 145 mm)

- installation with shims

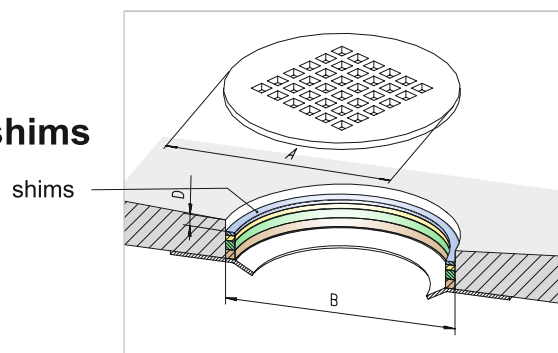

 round grate, Quadra Ø 120		
A	Ø 120 mm	
B	Ø 121 mm	+1/-0
D	5,0 mm	+1/-0
 round grate, Astra 145		
A	Ø 145	
B	Ø 146 mm	+1/-0
D	5,0 mm	+1/-0

Installation

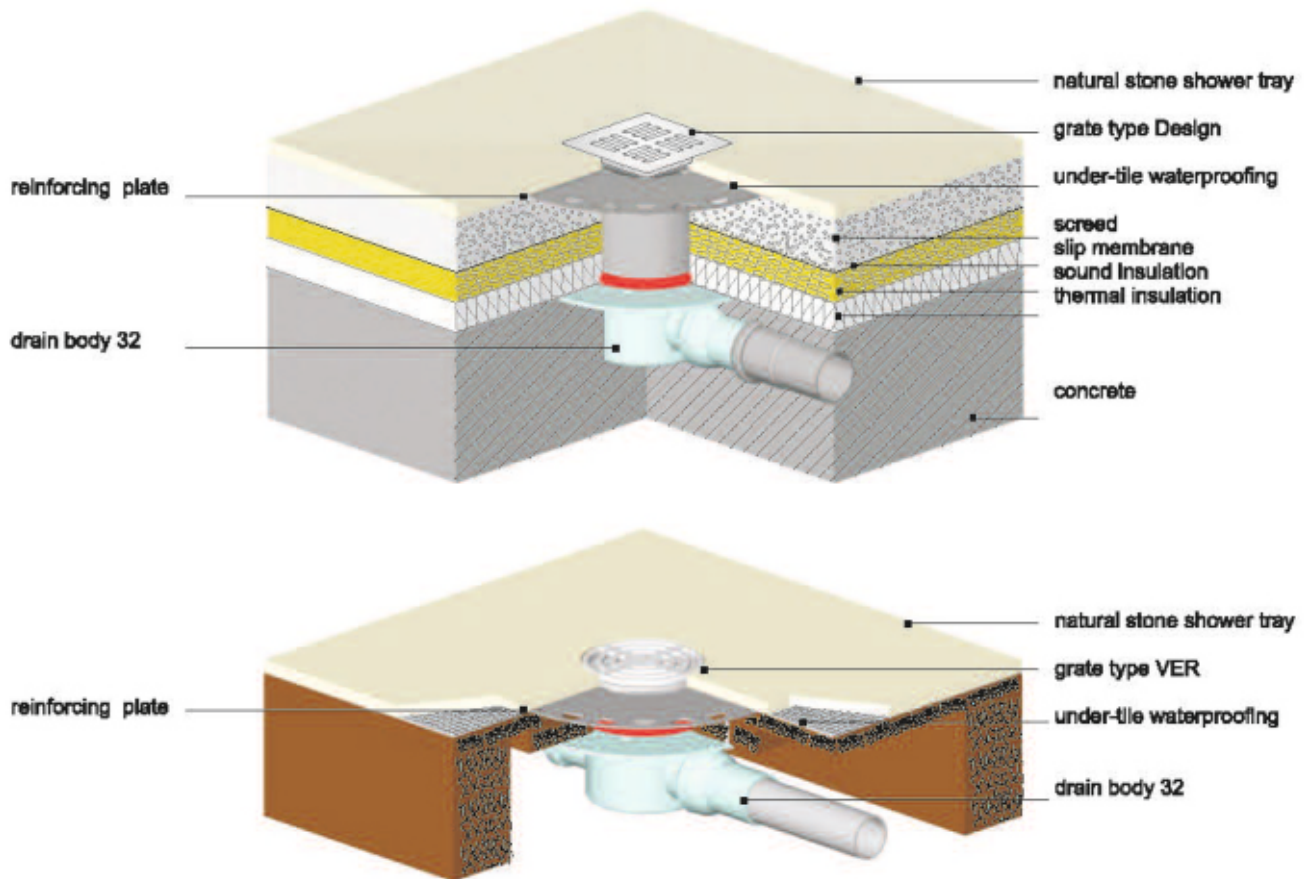

Grates



Quadra, 145 x 145 mm



Monogramm, 145 x 145 mm



Aquarius Ø 120 mm



Sol Ø 145 mm



**Quadra
120 x 120 mm**



**Monogramm
120 x 120 mm**



**Loire
120 x 120 mm**



**Selne
120 x 120 mm**



**Orinoco
120 x 120 mm**



**Nil
120 x 120 mm**



**Yukon
120 x 120 mm**

Note: Installation according to these instructions is a condition for considering any guarantee claim. Please see our conditions of sale and terms of delivery.